



**Electrolux**  
PROFESSIONAL

## Modular Cooking Range Line 700XP Electric Chip Scuttle

ITEM # \_\_\_\_\_

MODEL # \_\_\_\_\_

NAME # \_\_\_\_\_

SIS # \_\_\_\_\_

AIA # \_\_\_\_\_



371086 (E7CSEDC000)

Electric chip scuttle top with  
1 well

### Short Form Specification

Item No. \_\_\_\_\_

Heating via infrared heating elements positioned on the back of the unit. Perforated false bottom GN 1/1 specially shaped for easier food collection. One piece pressed worktop in 1.5 mm thick stainless steel. Easy to use control panel with ON/OFF switch. Exterior panels in stainless steel with Scotch Brite finish. Right-angled side edges to allow flush-fitting junction between units.

### Main Features

- Recommended for use next to a fryer to allow excess oil to drip in the well basin.
- Unit to have infrared heating elements positioned on the back of the unit to keep servings warm until ready to be plated and served.
- Well able to contain 1/1 GN container with a maximum height of 150 mm.
- Easy-to-use control panel.
- Unit supplied with a perforated GN 1/1 false bottom specially shaped for easier food collection.
- All major compartments located in front of unit for ease of maintenance.
- Suitable for countertop installation.

### Construction

- One piece pressed 1.5 mm work top in Stainless steel.
- All exterior panels in Stainless Steel with Scotch Brite finishing.
- Model has right-angled side edges to allow flush fitting joints between units, eliminating gaps and possible dirt traps.
- IPX4 water resistance certification.

APPROVAL: \_\_\_\_\_



Experience the Excellence  
[www.electroluxprofessional.com](http://www.electroluxprofessional.com)  
[professional@electrolux.com](mailto:professional@electrolux.com)



### Optional Accessories

|                                                |            |                          |
|------------------------------------------------|------------|--------------------------|
| • Junction sealing kit                         | PNC 206086 | <input type="checkbox"/> |
| • Support for bridge type installation, 800mm  | PNC 206137 | <input type="checkbox"/> |
| • Support for bridge type installation, 1000mm | PNC 206138 | <input type="checkbox"/> |
| • Support for bridge type installation, 1200mm | PNC 206139 | <input type="checkbox"/> |
| • Support for bridge type installation, 1400mm | PNC 206140 | <input type="checkbox"/> |
| • Support for bridge type installation, 1600mm | PNC 206141 | <input type="checkbox"/> |
| • Support for bridge type installation, 400mm  | PNC 206154 | <input type="checkbox"/> |
| • Chimney upstand, 400mm                       | PNC 206303 | <input type="checkbox"/> |
| • Right and left side handrails                | PNC 206307 | <input type="checkbox"/> |
| • - NOT TRANSLATED -                           | PNC 206308 | <input type="checkbox"/> |
| • Frontal handrail, 400mm                      | PNC 216046 | <input type="checkbox"/> |
| • Frontal handrail, 800mm                      | PNC 216047 | <input type="checkbox"/> |
| • Frontal handrail, 1200mm                     | PNC 216049 | <input type="checkbox"/> |
| • Frontal handrail, 1600mm                     | PNC 216050 | <input type="checkbox"/> |
| • Large handrail - portioning shelf, 400mm     | PNC 216185 | <input type="checkbox"/> |
| • Large handrail - portioning shelf, 800mm     | PNC 216186 | <input type="checkbox"/> |
| • 2 side covering panels for top appliances    | PNC 216277 | <input type="checkbox"/> |

Front

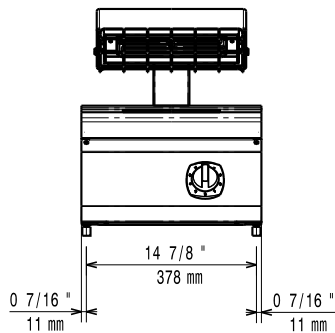

Side

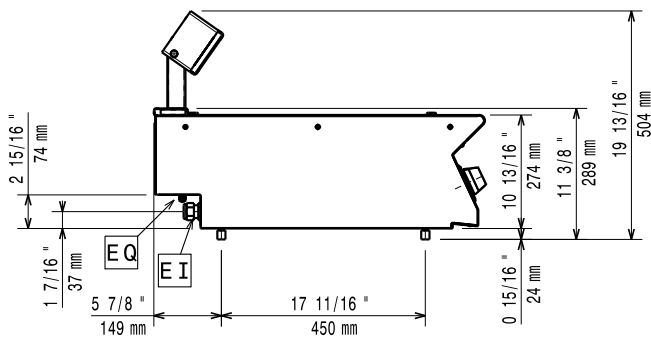

EI = Electrical inlet (power)

Top

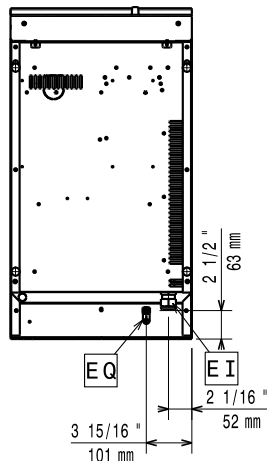

### Electric

Supply voltage:

371086 (E7CSEDC000) 220-230 V/1 ph/50-60 Hz

Electrical power max.:

1 kW

Total Watts:

1 kW

### Key Information:

Usable well dimensions

(width): 306 mm

Usable well dimensions

(height): 156 mm

Usable well dimensions

(depth): 510 mm

Net weight:

20 kg

Shipping weight:

27 kg

Shipping height:

650 mm

Shipping width:

460 mm

Shipping depth:

820 mm

Shipping volume:

0.25 m<sup>3</sup>

If appliance is set up or next to or against temperature sensitive furniture or similar, a safety gap of approximately 150 mm should be maintained or some form of heat insulation fitted.

[NOT TRANSLATED]

ECS7